

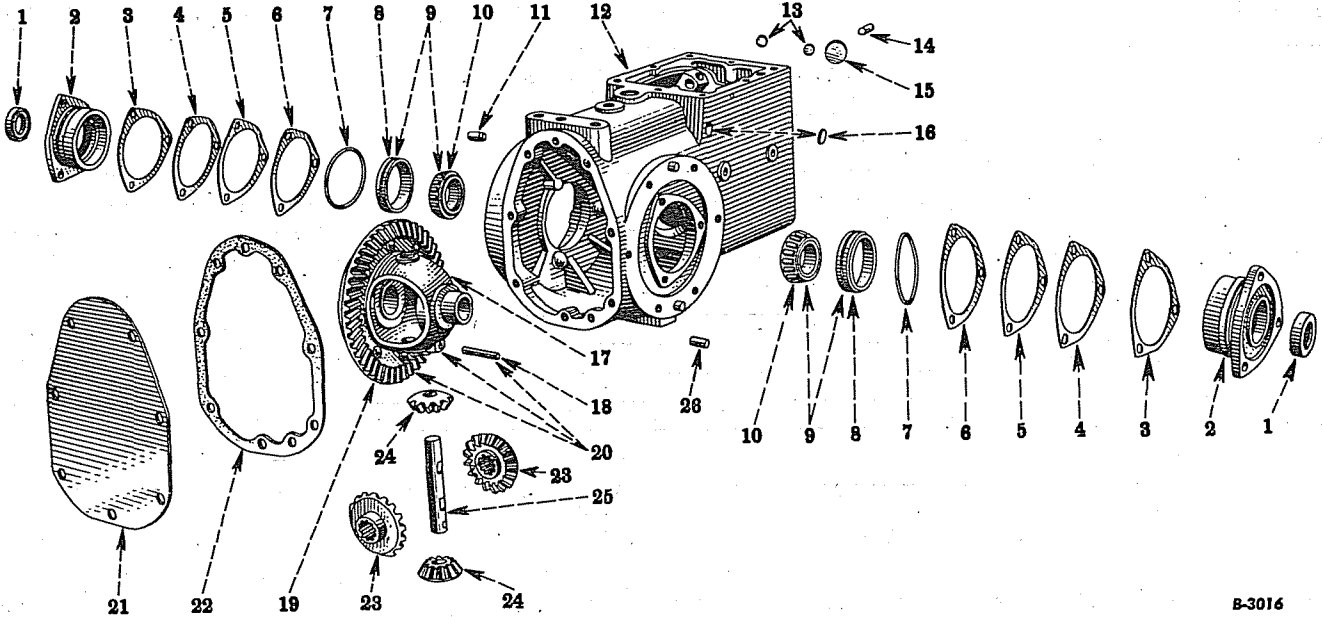

CHASSIS



B-3016

Reference numbers only are shown in illustration. Use I H part numbers in ordering.

TRANSMISSION CASE AND DIFFERENTIAL

1	18 674 K	OIL SEAL, DIFFERENTIAL SHAFT INNER BEARING RETAINER	2
2	350 792 R11 179 839 103 321	RETAINER, BEARING, DIFFERENTIAL, w/CUP, 13 822 V AND OIL SEAL, 18 674 K SCREW, CAP, HEX-HD., 3/8-16NC x 1" WASHER, LOCK, 3/8"	2 6 6
3	350 794 R1	SHIM, DIFFERENTIAL BEARING RETAINER, FINE	X
4	350 795 R1	SHIM, DIFFERENTIAL SHAFT INNER BEARING RETAINER, LIGHT	X
5	350 796 R1	SHIM, DIFFERENTIAL BEARING RETAINER, MEDIUM	X
6	350 797 R1	SHIM, DIFFERENTIAL BEARING RETAINER, HEAVY	X
7	350 793 R1	RING, SEAL, DIFFERENTIAL BEARING RETAINER	2
8	13 822 V	CUP, DIFFERENTIAL SHAFT INNER BEARING (TIMKEN No. 14274) (OPTIONAL WITH 352 396 R1)	2
8	352 396 R1	CUP, DIFFERENTIAL SHAFT INNER BEARING (BOWER-BT-14274) (OPTIONAL WITH 13 822 V)	2
9	10 873 K	BEARING, DIFFERENTIAL (TIMKEN) (CUP, 13 822 V AND CONE, 10 880 K) (OPTIONAL WITH 352 382 R91)	2
9	352 382 R91	BEARING, DIFFERENTIAL (BOWER) (CUP, 352 396 R1 AND CONE, 352 389 R91) (OPTIONAL WITH 10 873 K)	2
10	10 880 K	CONE, DIFFERENTIAL BEARING (TIMKEN No. 14138-A) (OPTIONAL WITH 352 389 R91)	2
10	352 389 R91	CONE, DIFFERENTIAL BEARING (BOWER 14138-A) (OPTIONAL WITH 10 880 K)	2
11	350 799 R1	DOWEL, TRANSMISSION CASE TO REAR AXLE HOUSING	2

X-AS REQUIRED