

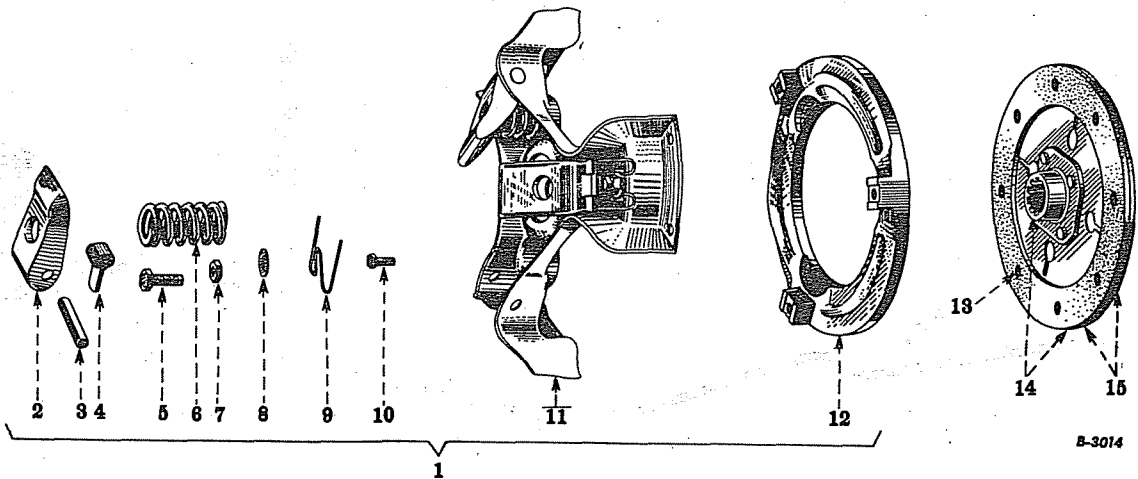

CHASSIS



B-3014

Reference numbers only are shown in illustration. Use I H part numbers in ordering.

CLUTCH (Atwood Vacuum Machine Company)

	350 938 R91	6500-5	CLUTCH, ASSEMBLY (6-1/2") (DRIVEN DISC AND PRESSURE PLATE, ASSEMBLY) (OPTIONAL WITH ROCKFORD CLUTCH, 350 941 R91)	1
1	350 939 R91	6501-7	PLATE, PRESSURE, CLUTCH, ASSEMBLY (COMPOSED OF -	1
			1 BRACKET 351 897 R1	
			3 LEVER 354 074 R1	
			3 NUT 351 899 R1	
			3 PIN 351 902 R1	
			1 PLATE 351 896 R1	
			3 SCREW 351 965 R1	
			3 SPRING 351 898 R1	
			3 SPRING 351 903 R1	
			3 SPRING 351 904 R1	
			3 WASHER 351 900 R1)	
2	354 074 R1	2626	LEVER, CLUTCH (WILL WORK FOR 351 901 R1)	3
3	351 902 R1	1130	PIN, CLUTCH LEVER	3
4	351 904 R1	1033	SPRING, CLUTCH LEVER	3
5	351 965 R1	2053	SCREW, ADJUSTING	3
6	351 903 R1	583	SPRING, PRESSURE, CLUTCH LEVER	3
7	351 899 R1	2819	NUT, LOCK, ADJUSTING SCREW	3
8	351 900 R1	2827	WASHER, ADJUSTING SCREW	3
9	351 898 R1	626	SPRING, RETURN, CLUTCH	3
10	2 049 Y		SCREW, CLUTCH TO FLYWHEEL CAP	6
	103 320		WASHER, LOCK, 5/16"	6
11	351 897 R1	581	BRACKET, CLUTCH	1
12	351 896 R1	584	PLATE, PRESSURE, CLUTCH	1
13	63 974 D	366	RIVETS, CLUTCH FACING	10
14	350 940 R91	6502-1	DISC, DRIVEN, CLUTCH	1
15	351 935 R91		PACKAGE, CLUTCH FACING (CONSISTS OF TWO FACINGS AND TEN RIVETS, 63 974 D)	1