

ATTACHMENTS

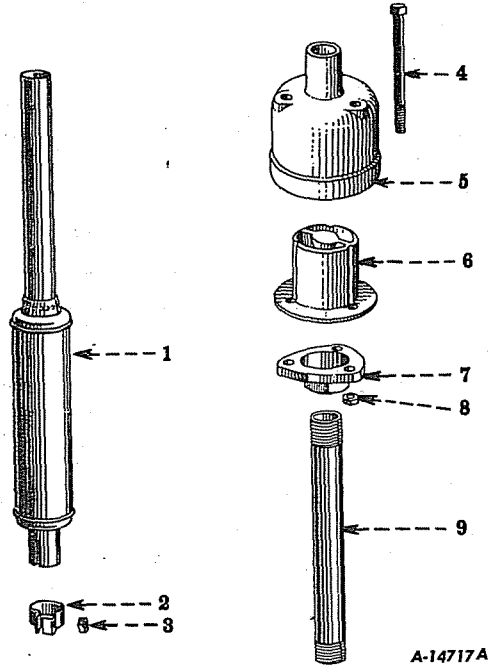

A-14717A

Reference numbers only are shown in illustration. Use I H part numbers in ordering.

EXHAUST MUFFLER AND SPARK ARRESTER (Special)

	351 435 R92	ATTACHMENT, EXHAUST MUFFLER (MACHINE ATTACHMENT)		
	351 642 R92	ATTACHMENT, SPARK ARRESTER (MACHINE ATTACHMENT)		
1	351 436 R92	MUFFLER, EXHAUST (OPTIONAL WITH 356 003 R91)		1
1	356 003 R91	MUFFLER, EXHAUST (OPTIONAL WITH 351 436 R92)		1
2	351 437 R1	CLAMP, EXHAUST MUFFLER		1
	181 374	SCREW, CAP, HEX-HD., 3/8-24NF x 4-1/2"		1
	103 321	WASHER, LOCK, 3/8"		1
3	93 082 H	NUT, EXHAUST MUFFLER CLAMP		1
4	16 290 R1	FOLLOWS REFERENCE NO. 5		
5	351 645 R1	TOP, SPARK ARRESTER	501 TO 135079	1
	16 290 R1	SCREW, CAP, HEX-HD., 3/8-24NF x 4-1/2"		3
5	353 829 R1	TOP, SPARK ARRESTER	135080 UP	1
	16 290 R1	SCREW, CAP, HEX-HD., 3/8-24NF x 4-1/2"		3
6	4 910 D	BODY, SPARK ARRESTER	501 TO 135079	1
6	353 265 R1	BODY, SPARK ARRESTER	135080 UP	1
7	351 644 R1	BASE, SPARK ARRESTER		1
8	93 082 H	NUT, SPARK ARRESTER BASE		3
9	351 643 R1	PIPE, EXHAUST		1