

5. Remove the belt pulley retaining cap screw, and remove the belt pulley (44) and spacers from the pulley drive shaft (34).

6. Remove the cap screws, and remove the drive shaft oil seal retainer (40), drive shaft bearing cage (37) and

shims (36) and outer bearing (38).

**NOTE:** Retain the shims (36) for use in reassembly.

7. Remove the belt pulley drive shaft (34) and inner bearing (35) out of the drive housing (22).

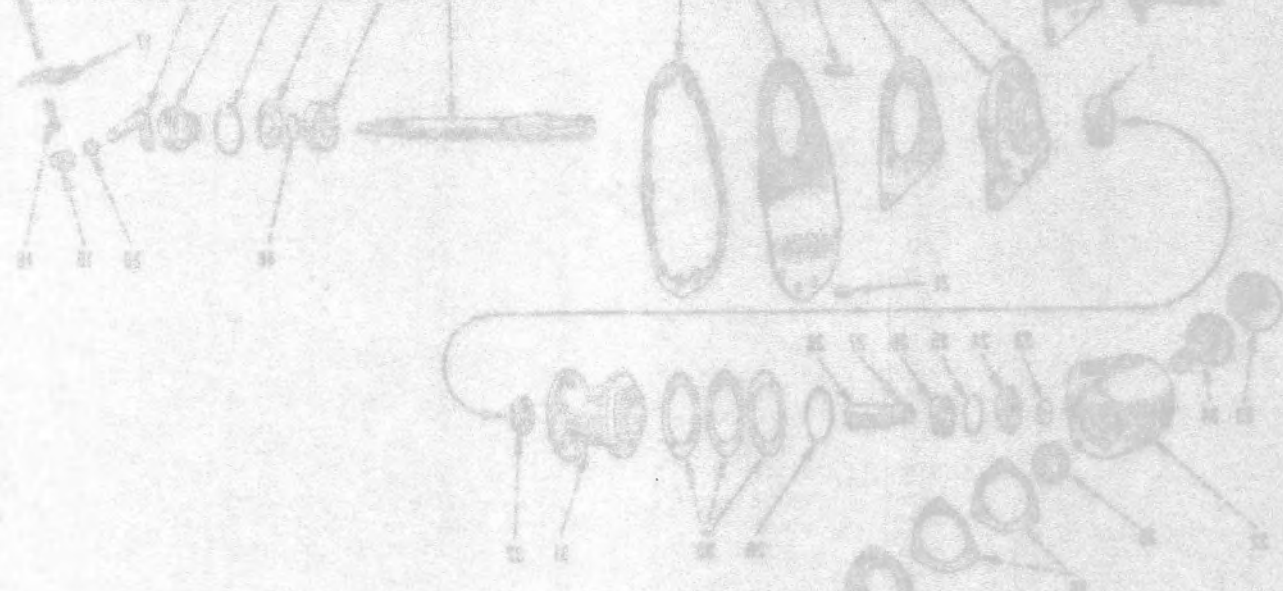

## Inspection and Repair

1. Inspect the bearings for wear or damage and replace as necessary.

2. Inspect the gears for wear and damaged teeth. Inspect the shaft for signs of wear or damage.

3. Check the drive housing for cracks and replace if necessary.

4. Be sure to use new gaskets and oil seals in reassembly.